



# Optical Fiber Identifier

## Ascentac OCI630

Efficient Identification of Target Fiber Without Damage or Signal Interruption

### Feature

- Fast 6-channel testing within 1.5s
- Support live testing
- Compatible with 1x8 optical splitters
- Built-in VFL
- Non-damaging macro-bend testing
- 20-Hour Battery Life

### Application

- Data center line testing
- Optical splitter line testing

### Introduction

Ascentac FiberGo OCI630 Series, Optical Fiber Identifier, is used for data center line testing. It allows for simultaneous testing of up to 6 optical fiber channels without interrupting services or damaging the fibers.

It quickly and accurately identifies the target fiber and its signal transmission direction. With a high dynamic range, it accurately tests through 1x8 optical splitters.

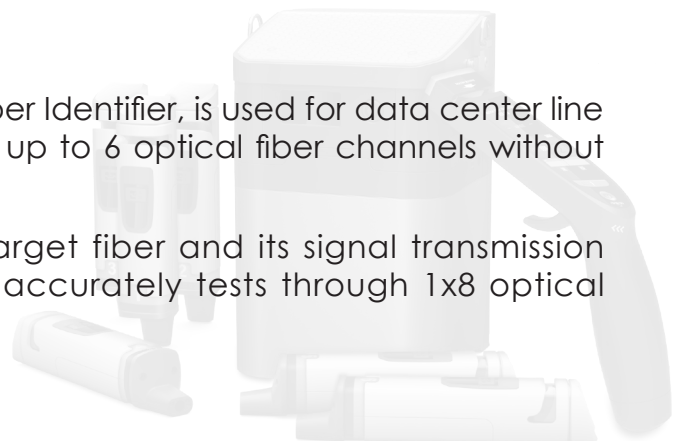

## Main Unit

- 1 Power switch
- 2 LCD display screen
- 3 Ear hook
- 4 Signal transmitter status indicator
- 5 Type-C

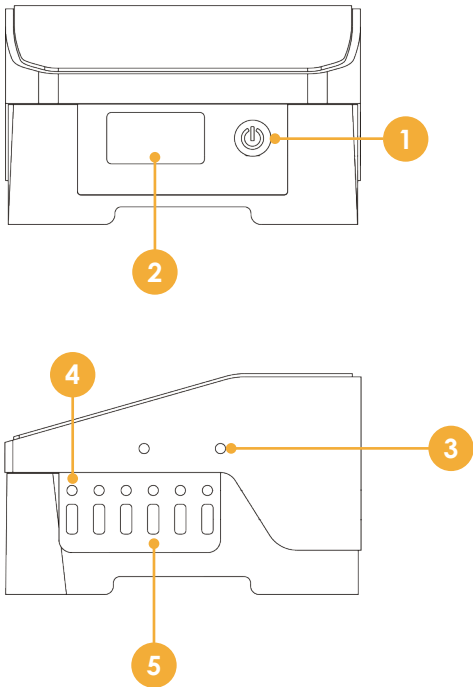

## Battery

- 1 Power switch
- 2 Battery indicator
- 3 Charging port
- 4 Battery release latch

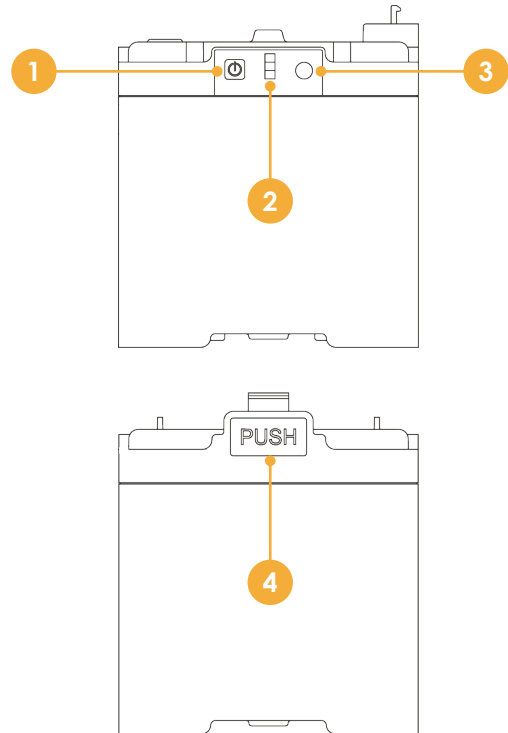

## Optical Fiber Identifier

- 1 Lighting
- 2 Fiber clamp tray
- 3 Front direction indicator
- 4 LCD display
- 5 Function button (○)
- 6 Function button (+)
- 7 Test handle
- 8 Power / Back button
- 9 Side direction indicator
- 10 Battery compartment
- 11 VFL
- 12 OPM
- 13 Dust cover

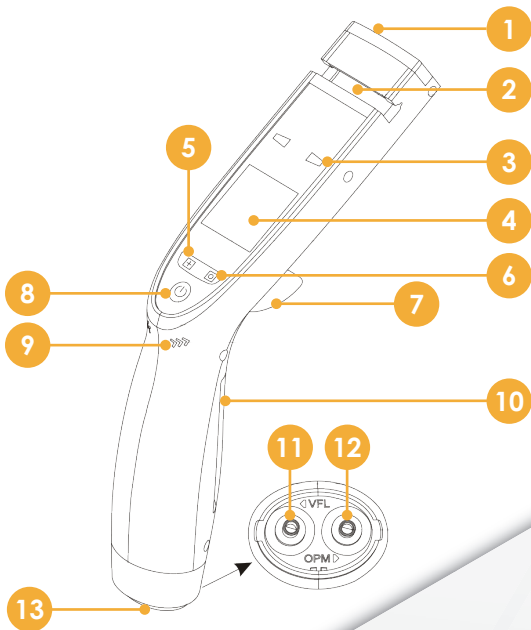

## Signal Transmitter

- 1 Push button and optical fiber clamp
- 2 Fiber tray
- 3 Momentary switch

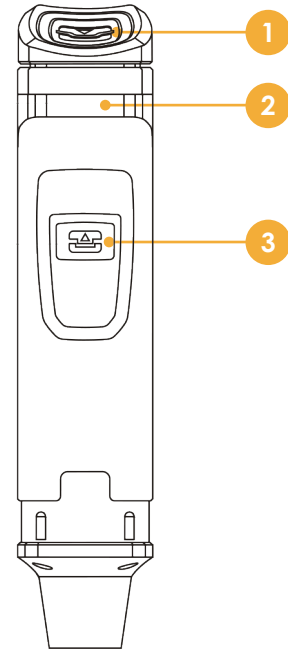

## | Status (Displayed on Screen)

Signal Transmitter ID  
Successfully connected

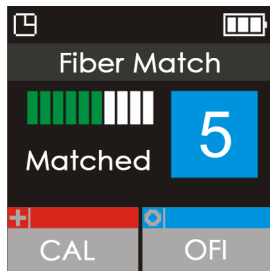

X  
Not connected

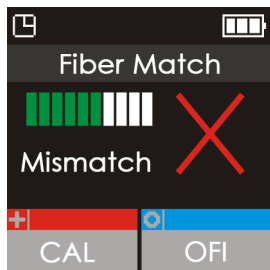

Low  
The fiber is a dark fiber

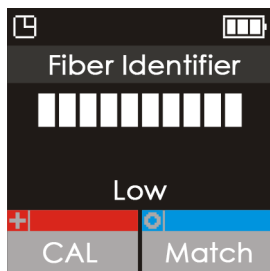

## | Application

OCI630 Series can quickly identify live or dark fibers. With signal transmitters, it can further identify the signal of a specific fiber-optic line, accurately targeting the correct fiber in a complex fiber-optic environment.



## Specification

Battery	
Capacity (mAh)	15600
Voltage (V)	12 to 18
Charging Time (hours)	8
Battery Life (hours)	20
L x W x H (mm)	126 x 111 x 175
Weight (g)	1740
Signal Transmitter	
Frequency (Hz)	5 to 16
Fiber Type (mm)	2.0, 3.0
Macro-bend Loss (dB)	1 to 3
Fiber Length (m)	1
L x W x H (mm)	27 x 27 x 132
Weight (g)	100
Optical Fiber Identifier	
Identification Time (seconds)	1.5
Wavelength (nm)	1310, 1490, 1550
Fiber Type (mm)	2.0, 3.0
Macro-bend Loss (dB)	2
Test Range (dBm)	2.0mm: -25 to +5 @1550nm 3.0mm: -20 to +10 @1550nm
L x W x H (mm)	96 x 37 x 195
Weight (g)	140
Visual Fault Locator	
Wavelength (nm)	650 ± 15
Output Power (mW)	1
Modulation Output	Continuous wavelength (C W ), pulsed (2Hz)
Optical Connector	Universal 2.5mm
Standard Accessories	
Main unit, battery, 6 signal transmitters, optical fiber identifier, charger, power cable, optical fiber clamps and accessories, light shield, 2 AAA batteries, carrying case, 1-year warranty.	

## Ordering Information

**OCI 01-00630**

**Example:** OCI 01-00630



© Copyright 2025 Ascentac. All rights reserved. The information in this document is subject to change without notice.

For the latest information regarding this product, please visit our website at <http://www.ascentac.com>



Contact us